

South Carolina Department of Transportation
Traffic Engineering Guidelines

NUMBER: TG-17

SUBJECT: Signing for One-Lane, Two-Way Bridges and One-Lane, Two-Way Roadway Sections

BACKGROUND: Section 2C.19 of the MUTCD provides guidance on the use of the “ROAD NARROWS” (W5-1) sign. It states that “a W5-1 sign should be used in advance of a transition on two-lane roads where the pavement width is reduced abruptly to a width such that vehicles traveling in opposite directions cannot simultaneously travel through the narrow portion of the roadway without reducing speed.” No guidance is provided concerning widths where vehicles cannot pass without yielding to another.

Section 2C.21 of the MUTCD provides guidance on the use of the “ONE LANE BRIDGE” (W5-3) sign. No other guidance is provided concerning additional signing.

The MUTCD allows the use of a “TO ONCOMING TRAFFIC” (R1-2aP) plaque under a “YIELD” (R1-2) sign where drivers proceeding straight ahead must yield to traffic approaching from the opposite direction. Examples are a one-lane, two-way bridge or a one-lane, two-way roadway section.

GUIDELINE: Traffic Engineering has designed a sign (W5-3.1) with the legend “ONE LANE ROAD” to use at one-lane, two-way roadway sections. The criteria for this sign should be based on the criteria of the “ONE LANE BRIDGE” (W5-3) sign in section 2C.21 of the MUTCD. The attached typical was developed for locations that require signing in addition to the “ONE LANE BRIDGE” (W5-3) signs and for locations that may require signing for one-lane, two-way roadway sections such as underpasses and culverts. The need may be based upon traffic volumes, truck traffic, the length of the one-lane bridge or roadway section, or the approach visibility of the bridge or roadway section.

Approved: _____



Director of Traffic Engineering

12-20-2018

Date

Original Guideline Signed on April 3, 2008

TYPICAL FOR SIGNING OF ONE LANE BRIDGES, CULVERTS, OR OTHER ONE LANE ROADWAY SECTIONS WITH TWO-WAY TRAFFIC

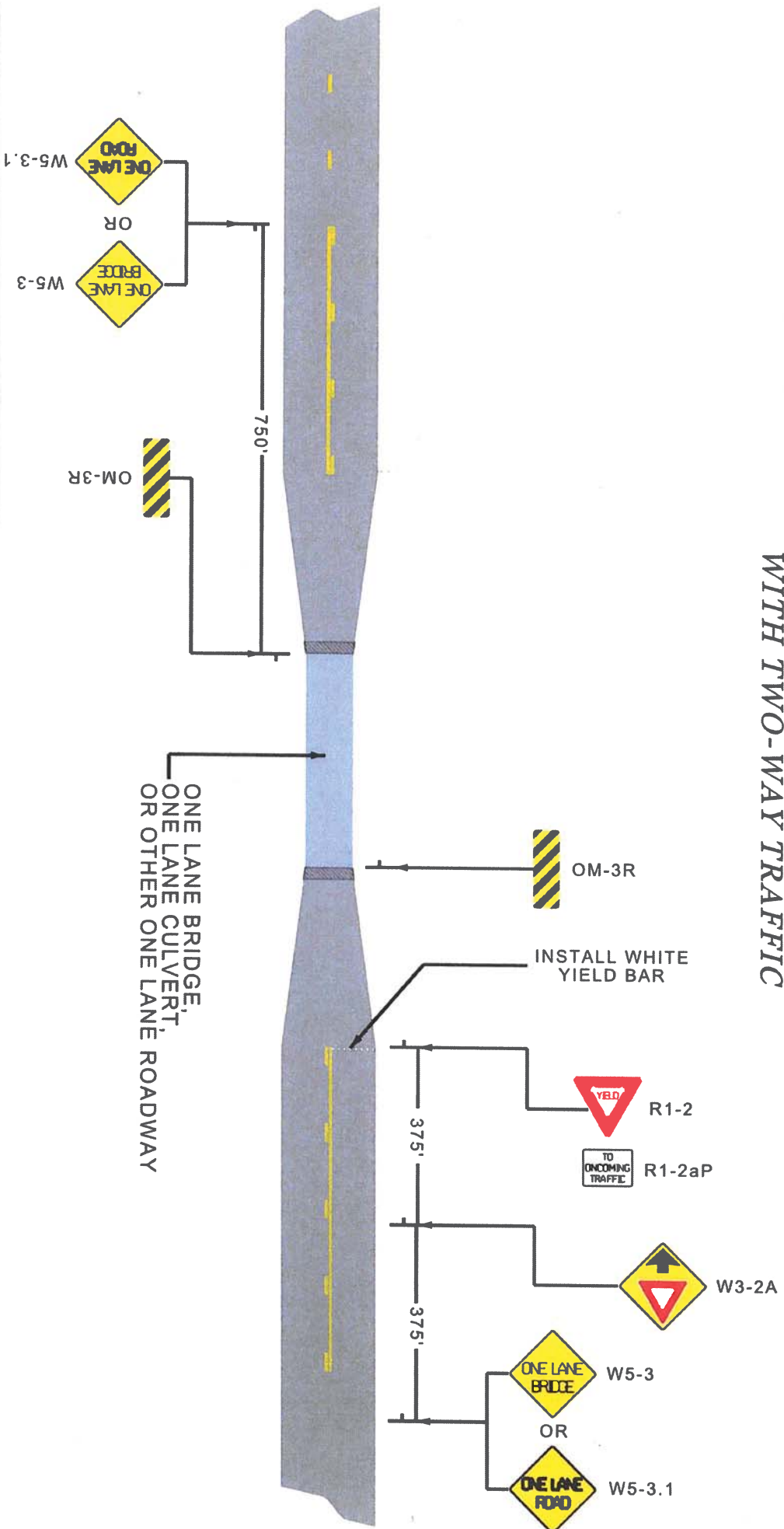

NOTES:

- 1.) THE CENTERLINE PAVEMENT MARKINGS ARE OPTIONAL.
- 2.) THE YIELD SIGN AND OTHER RELATED SIGNING SHOULD BE ERRECTED ON THE APPROACH WITH THE BEST POSSIBLE SIGHT DISTANCE.
- 3.) USE W5-3 SIGN FOR ONE LANE BRIDGES;
USE W5-3.1 SIGN FOR OTHER ONE LANE ROADWAY SECTIONS



TRAFFIC ENGINEERING

DATE: February 4th, 2009